

TPMS SERVICE KIT

Instruction Manual

- *OE TPMS Valve Supplier*
- *GM, Ford, Chrysler, Volkswagen, Fiat, Nissan, Hyundai and Kia official supplier of tire valves*
- *One of the Largest Valve Manufactures in the World*



Replacing your TPMS service kits with every tire change!

From November 2014, TPMS (Tire Pressure Monitoring System) has been mandatory for new vehicles in Europe. More and more vehicles are installed with direct TPMS. There are snap-in and clamp-in TPMS sensors in the market. In the case of clamp-in TPMS sensor, the TPMS service kit usually contains the following components: valve core, valve nut, valve cap, rubber grommet and washer. In order to prevent the malfunctions of sensors, it is recommended that the TPMS service kit components or TPMS snap-in valve should be replaced every time the tire is changed.

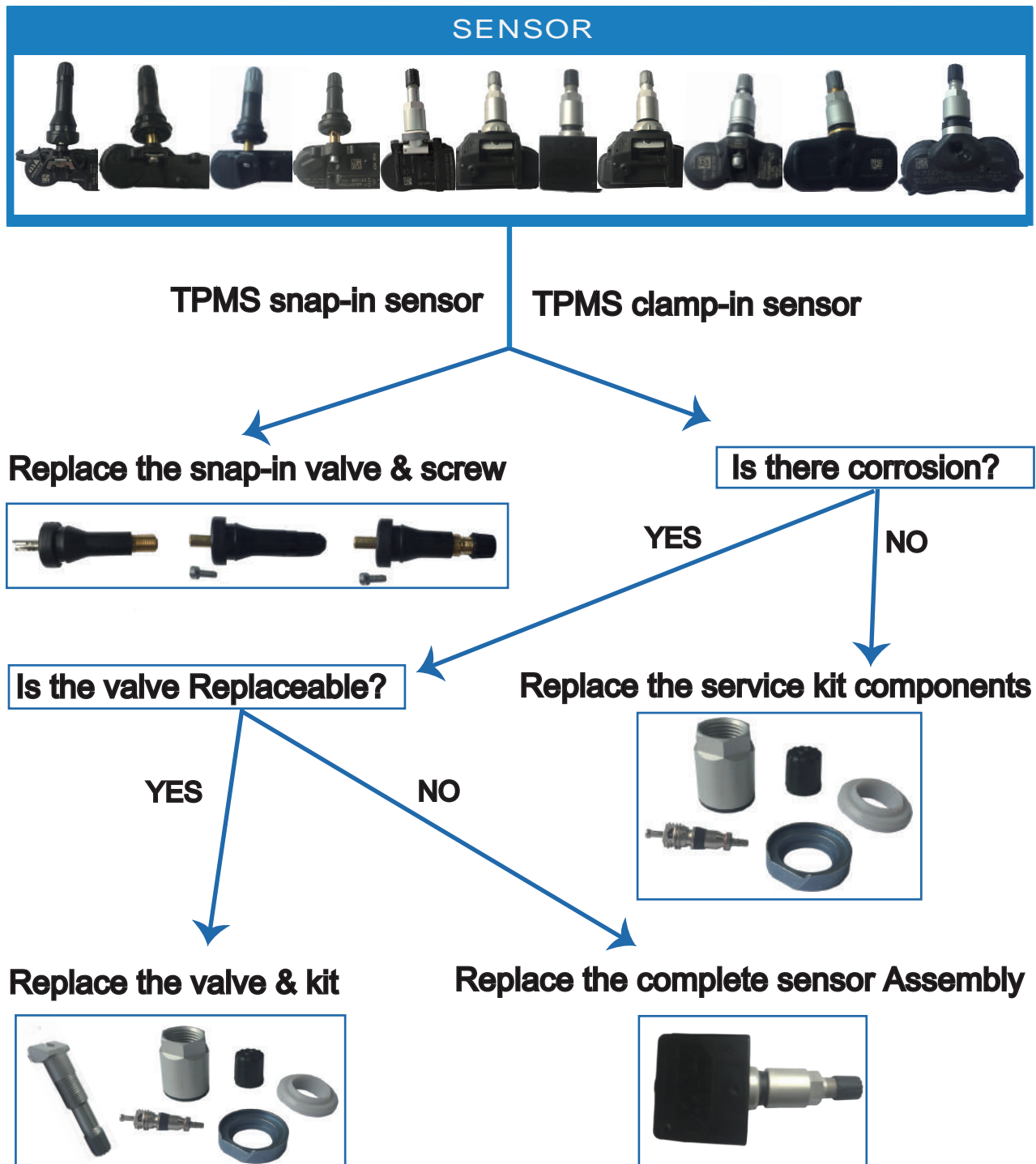

CONTENT

TPMS SERVICE KITS FOR CONTINENTAL SENSORS (NO.2001-2015)

TG1B	1
TG1C	2
MB	3
TG1D	3-4

TPMS SERVICE KITS FOR SCHRADER SENSORS (NO.3001-3022)

GEN 2/3	4-5
GEN 4	5-6
GEN J	6
GEN ALPHA	7
GEN GAMMA	8
SI/FARADAY	8-9

TPMS SERVICE KITS FOR HUF SENSORS (NO.4001-4012)

GEN 1	9-11
GEN 2	11
INTELLISENS	12

TPMS SERVICE KITS FOR LEAR SENSORS (NO.5007-5009)

LEAR SENSORS	12
--------------	----

TPMS SERVICE KITS FOR BAOLONG SENSORS (NO.5010-5012)

BAOLONG SENSORS	13
-----------------	----

TPMS SERVICE KITS FOR TRW SENSORS (NO.5001-5004)

GEN 1	14
GEN 2/3	14
GEN 4	14-15

TPMS SERVICE KITS FOR PACIFIC SENSORS (NO.5005-5006)

GEN 1/2/3	15
-----------	----

TPMS SERVICE KITS FOR CUB Uni-SENSORS (NO.6001-6004)

CUB Uni-SENSORS	16
-----------------	----

TPMS SERVICE KITS FOR ALLIGATOR SenS.IT (NO.6005-6006)

ALLIGATOR SenS.IT	17
-------------------	----

TPMS SERVICE KITS FOR HAMATON T-PRO (NO.6007-6009)

HAMATON T-PRO	18
---------------	----

TPMS SERVICE KITS FOR CONTINENTAL SENSORS

TG1B



ASSEMBLY INSTRUCTION

Please make sure that the larger diameter of the washer and rubber grommet face toward the sensor during installation.

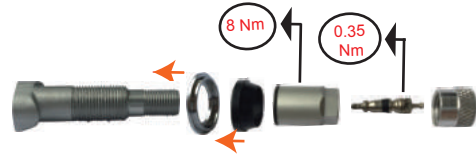

New P/N: 2001

Baolong OLD P/N	TPMSRFM	
Schrader old P/N	65658-KD	
Schrader new P/N	5005	
Description	Service kit for Conti TG1B	
Model	Renault	
Nut torque	8.5 Nm	

BLHN71

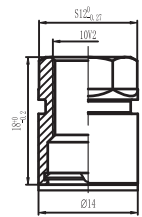

New P/N : 2002

Baolong OLD P/N	TPMSRFT	
Schrader old P/N	65659-KD	
Schrader new P/N	5006	
Description	Service kit for Conti TG1B	
Model	Chrysler, Citroen, Dodge, Fiat, Hyundai, Jaguar, Jeep, Kia, Lancia, Land Rover, Peugeot	
Nut torque	8.0 Nm	

BLHN42

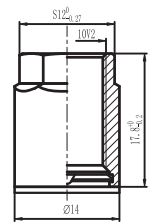

New P/N : 2003

Baolong OLD P/N	TPMSRFN	
Schrader old P/N	65660-KD	
Schrader new P/N	5007	
Description	Service kit for Conti TG1B	
Model	VW	
Nut torque	8.0 Nm	

BLHN72

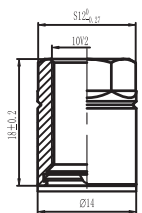

New P/N : 2004

Baolong OLD P/N	TPMSRFAX	
Schrader old P/N	65768-KU	
Schrader new P/N	5014	
Description	Service kit for Conti TG1B	
Model	Hyundai, Kia	
Nut torque	8.0 Nm	

BLHN73

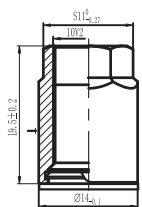

New P/N : 2005

Baolong OLD P/N	BLV741	
Schrader old P/N	N/A	
Schrader new P/N	N/A	
Description	Service kit for Conti TG1B	
Model	Chrysler, Citroen, Dodge, Fiat, Hyundai, Jaguar, Jeep, Kia, Lancia, Land Rover, Peugeot, Renault, VW	
Nut torque	8.0 Nm	

BLV741

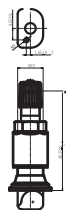

TG1C



ASSEMBLY INSTRUCTION

- 1) During the installation of the rubber grommet, please make sure that the large diameter of the rubber grommet face the sensor.
- 2) During the installation of the washer, please make sure that the chamfer of washers point downwards.
(Please refer to Pic.2)

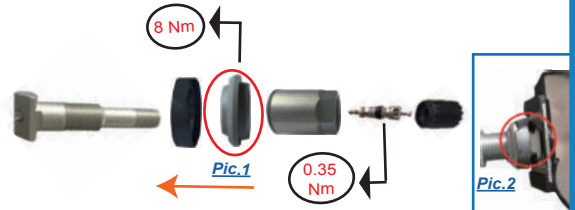

New P/N : 2006

Baolong OLD P/N	TPMSRFR	
Schrader old P/N	65963-KU	
Schrader new P/N	5018	
Description	Service Kit for Conti TG1C Renault	
Model	Renault	
Nut torque	8 Nm	

BLHN71

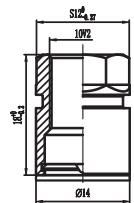

New P/N : 2007

Baolong OLD P/N	TPMSRFAD	
Schrader old P/N	66070-KU	
Schrader new P/N	5020	
Description	Service Kit for Conti TG1C	
Model	Ford, Honda, Jaguar, Land Rover, Suzuki, Volvo	
Nut torque	8 Nm	

BLHN42

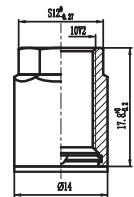

New P/N : 2008

Baolong OLD P/N	TPMSRFAA	
Schrader old P/N	66071-KU	
Schrader new P/N	5021	
Description	Service Kit for Conti TG1C	
Model	Hyundai, Kia	
Nut torque	8 Nm	

BLHN60

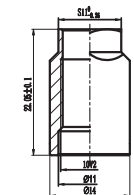

New P/N : 2009

Baolong OLD P/N	TPMSRFAB	
Schrader old P/N	66072-KU	
Schrader new P/N	5022	
Description	Service Kit for Conti TG1C	
Model	Mazda	
Nut torque	8 Nm	

BLHN89

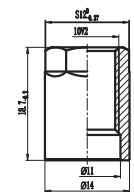

New P/N : 2010

Baolong OLD P/N	BLV491	
Schrader old P/N	43171-68	
Schrader new P/N	8002/8003	
Description	Clamp-in aluminum valve stem with core and cap for Conti TG1C	
Model	Ford, Honda, Hyundai, Jaguar, Kia, Land Rover, Mazda, Renault, Suzuki, Volvo	

BLV491

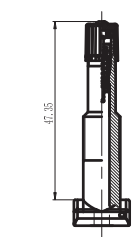

MB

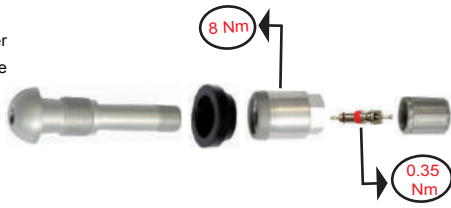
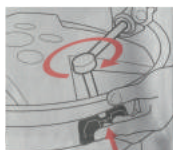
	<p>ASSEMBLY INSTRUCTION</p> <p>Please make sure that the larger diameter of the rubber grommet face toward the sensor during installation.</p>		
---	---	--	---

New P/N : 2011

Baolong OLD P/N	TPMSRFU	
Schrader old P/N	Service kits for Conti MB	
Schrader new P/N	N/A	
Description	N/A	
Model	Mercedes, VW	
Nut torque	6.0 Nm	

BLHN86



New P/N : 2012

Baolong OLD P/N	BLV475	
Schrader old P/N	65661-KU	
Schrader new P/N	5008	
Description	Clamp-in aluminum valve for Conti MB	
Model	Mercedes	
Nut torque	6.0 Nm	

BLV475

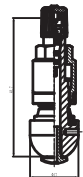



New P/N : 2013

Baolong OLD P/N	BLV495	
Schrader old P/N	65958-KU	
Schrader new P/N	5015	
Description	Clamp-in aluminum valve for Conti MB	
Model	Mercedes, VW	
Nut torque	6.0 Nm	

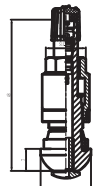
BLV495



TG1D

	<p>ASSEMBLY INSTRUCTION</p> <p>1) Verify that the sensor housing is disassembled from the rubber valve before assembly, the sensor housing and rubber valve can be unlocked by pressing and holding the clip "PRESS".</p> <p>2) Please make sure that the rib on the rubber valve stem is pointing toward the outside of the rim when install the rubber valve to the rim.</p> <p>3) Attach the sensor housing to the valve stem, then firmly but carefully pull on the housing to check that the housing is correctly locked on the valve stem.</p>	
---	---	--

New P/N : 2014

Baolong OLD P/N	BLV453	 <p style="background-color: #007bff; color: white; padding: 2px; display: inline-block; border-radius: 5px;">MAX 180km/h</p>
Schrader old P/N	N/A	
Schrader new P/N	N/A	
Description	Snap-in valve with roll pin for Conti TG1D	
Model	Afa Romeo, Citroen, Fiat, Jeep, Mitsubishi, Peugeot, Renault	
Screw torque	clip-in	

BLV453

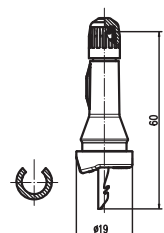

New P/N : 2015

Baolong OLD P/N	BLV720	
Schrader old P/N	N/A	
Schrader new P/N	N/A	
Description	Clamp-in brass valve with roll pin for Conti TG1D	
Model	N/A	
Nut torque	4.0 Nm	
Screw torque	clip-in	

BLV720

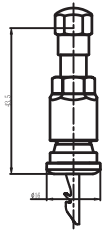

TPMS SERVICE KITS FOR SCHRADER SENSORS

GEN 2/3



ASSEMBLY INSTRUCTION

Please make sure that the larger diameter of the rubber grommet face toward the sensor during installation.



New P/N : 3001

Baolong OLD P/N	TPMSRFI	
Schrader old P/N	65654-KD	
Schrader new P/N	5001	
Description	Service kit for Schrader Gen 2/3	
Model	Renault	
Nut torque	4.25 Nm	

BLHN75

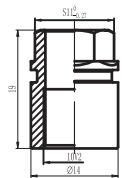

New P/N : 3002

Baolong OLD P/N	TPMSRFJ	
Schrader old P/N	65655-KD	
Schrader new P/N	5002	
Description	Service kit for Schrader Gen 2/3	
Model	Renault	
Nut torque	7.5 Nm	

BLHN68

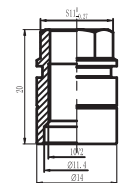

New P/N : 3003

Baolong OLD P/N	TPMSRFK	
Schrader old P/N	65656-KD	
Schrader new P/N	5003	
Description	Service kit for Schrader Gen 2/3	
Model	Alfa Romeo, Chrysler, Citroen, Fiat, Hyundai, Kia, Lancia, Peugeot	
Nut torque	4.25 Nm	

BLHN43

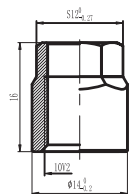

New P/N : 3004

Baolong OLD P/N	TPMSRFL	
Schrader old P/N	65657-KD	
Schrader new P/N	5004	
Description	Service kit for Schrader Gen 2/3	
Model	Chevrolet, Lotus, Nissan, Opel, Saab, Vauxhall, Volvo	
Nut torque	8.0 Nm	

BLHN70

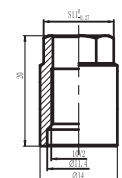

New P/N : 3005

Baolong OLD P/N	TPMSRFP
Schrader old P/N	65961-KD
Schrader new P/N	5016
Description	Service kit for Schrader Gen 2/3
Model	Infiniti, Nissan, Renault
Nut torque	8.0 Nm



BLHN66

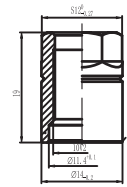

New P/N : 3006

Baolong OLD P/N	TPMSRFAK
Schrader old P/N	20003
Schrader new P/N	N/A
Description	Service kit for Schrader Gen 2/3
Model	Cadillac, Chrysler, Dodge, Isuzu, Jeep, Mitsubishi, Plymouth, Volvo
Nut torque	4.0 Nm



TRHN30

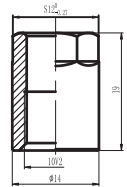

New P/N : 3007

Baolong OLD P/N	TPMSRFAU
Schrader old P/N	20005
Schrader new P/N	N/A
Description	Service kit for Schrader Gen 2/3
Model	Infiniti, Nissan
Nut torque	7.5 Nm



BLHN65

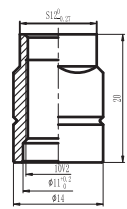

GEN 4



ASSEMBLY INSTRUCTION

Please note the brass end shape of the rubber valve stem match the sensor housing during installation. The recommended installation torque of the screw is 1.4 Nm.



New P/N : 3008

Baolong OLD P/N	BLV450-3
Schrader old P/N	66118-68
Schrader new P/N	5026, 5028
Description	Snap-in valve for Schrader Gen 4
Model	Abarth, Alfa Romeo, Buick, Cadillac, Chevrolet, Chrysler, Citroen, Dodge, Fiat, Ford, Gmc, Hummer, Hyundai, Jeep, Lancia, Mahindra, Mazda, Opel, Peugeot, Ssangyong, Vauxhall
Nut torque	N/A
Screw torque	1.4 Nm



BLV450-3

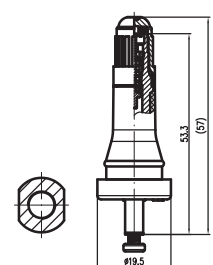

New P/N : 3009

Baolong OLD P/N	TPMSRFBDD
Schrader old P/N	66087-KD
Schrader new P/N	5025
Description	Service kit for clamp-in aluminum valve for Schrader Gen 4
Model	GM, PSA, Chrysler, Ford, Hyundai, Kia, Alfa Romeo
Nut torque	8.0Nm
Screw torque	1.4 Nm



BLHN66

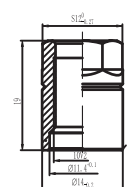

New P/N : 3010

Baolong OLD P/N	BLV478	
Schrader old P/N	66086-68	
Schrader new P/N	5024	
Description	Clamp-in aluminum valve for Schrader Gen 4	
Model	Abarth, Alfa Romeo, Buick, Cadillac, Chevrolet, Chrysler, Citroen, Dodge, Fiat, Ford, Gmc, Hummer, Hyundai, Jeep, Lancia, Mahindra, Mazda, Opel, Peugeot, Ssangyong, Vauxhall	
Nut torque	6.0 Nm	
Screw torque	1.4 Nm	

BLV478

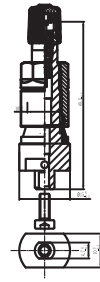

New P/N : 3011

Baolong OLD P/N	BLV493A	
Schrader old P/N	N/A	
Schrader new P/N	N/A	
Description	Clamp-in aluminum valve for Schrader Gen 4	
Model	Abarth, Alfa Romeo, Buick, Cadillac, Chevrolet, Chrysler, Citroen, Dodge, Fiat, Ford, Gmc, Hummer, Hyundai, Jeep, Lancia, Mahindra, Mazda, Opel, Peugeot, Ssangyong, Vauxhall	
Nut torque	4.0 Nm	
Screw torque	1.4 Nm	

BLV493A

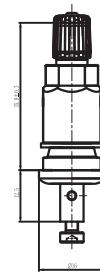

New P/N : 3012

Baolong OLD P/N	BLV723	
Schrader old P/N	N/A	
Schrader new P/N	5038	
Description	Clamp-in brass valve for Schrader Gen 4	
Model	N/A	
Nut torque	8.0 Nm	
Screw torque	1.4 Nm	

BLV723

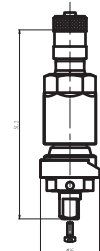

GEN J

ASSEMBLY INSTRUCTION

Please make sure that the larger diameter of the rubber grommet face toward the sensor during installation.

New P/N : 3013

Baolong OLD P/N	TPMSRFAV	
Schrader old P/N	66138-KD	
Schrader new P/N	5027	
Description	Service kit for Schrader Gen J	
Model	Cadillac, Chevrolet	
Nut torque	6.0 Nm	

BLHN43



New P/N : 3014

Baolong OLD P/N	TPMSRFAJ	
Schrader old P/N	66700-KD	
Schrader new P/N	5030	
Description	Service kit for Schrader Gen J	
Model	Cadillac, Chevrolet	
Nut torque	4.25 Nm	

TRHN30



GEN ALPHA



ASSEMBLY INSTRUCTION

Please make sure that the washer at the bottom of the valve stem is placed form-locking onto the sensor. The sensor angle can be adjusted accordingly on the rim.

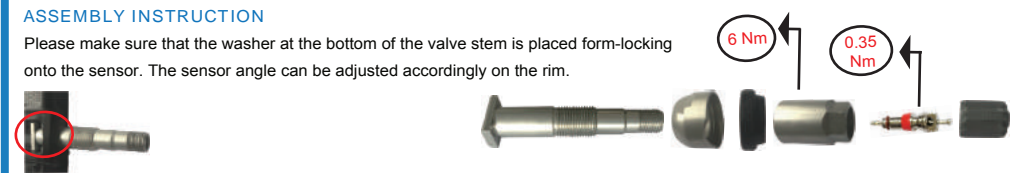

New P/N : 3015

Baolong OLD P/N	TPMSRFAC	
Schrader old P/N	65962-KD	
Schrader new P/N	5017	
Description	Service kit for Schrader Gen Alpha	
Model	Chrysler, Dodge, Mercedes, Smart, VW	

BLHN74

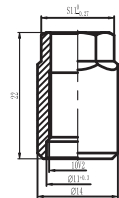

New P/N : 3016

Baolong OLD P/N	TPMSRFS	
Schrader old P/N	65964-KD	
Schrader new P/N	5019	
Description	Service kit for Schrader Gen Alpha	
Model	Chrysler, Dodge, Jeep, Lancia	
Nut torque	6.0 Nm	

BLHN69

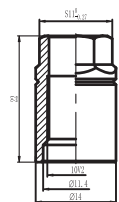

New P/N : 3023

Baolong OLD P/N	TPMSRFBN	
Schrader old P/N	66699-KD	
Schrader new P/N	5029	
Description	Service kit for Schrader Gen Alpha	
Model	Chrysler, Dodge	
Nut torque	6.0 Nm	

BLHN70

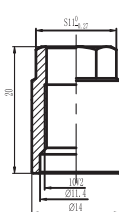

New P/N : 3017

Baolong OLD P/N	BLRW65-1	
Schrader old P/N	N/A	
Schrader new P/N	8034	
Description	Special dome washer for Schrader Gen-Alpha	
Model	Chrysler, Dodge, Jeep, Lancia, Mercedes, Smart, VW	

BLRW65-1



New P/N : 3018

Baolong OLD P/N	BLV473	
Schrader old P/N	43148-67	
Schrader new P/N	8001	
Description	Clamp-in aluminum valve stem with special dome washer for Schrader Gen-Alpha	
Model	Chrysler, Dodge, Jeep, Lancia, Mercedes, Smart, VW	
Nut torque	6.0 Nm	

BLV473



GEN GAMMA



ASSEMBLY INSTRUCTION

Please make sure that the washer at the bottom of the valve stem is placed form-locking onto the sensor. The sensor angle can be adjusted accordingly on the rim.



New P/N : 3019

Baolong OLD P/N	BLV716
Schrader old P/N	5037/5056
Schrader new P/N	5037, 5056
Description	Clamp-in aluminum valve for Schrader Gen Gamma
Model	Alfa Romeo, Citroen, Fiat, Maserati, Mercedes, Opel, Peugeot, Vauxhall
Nut torque	6.0 Nm

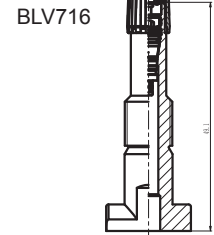

GEN SI/FARADAY



ASSEMBLY INSTRUCTION

Please note the brass end shape of the rubber valve stem match the sensor housing during installation. The recommended installation torque of the screw is 1.4 Nm.



New P/N : 3020

Baolong OLD P/N	BLV460
Schrader old P/N	66742-68
Schrader new P/N	5033
Description	Snap-in high speed valve for Schrader SI/Faraday
Model	Chevrolet, Citroen, Dacia, Fiat, Ford, Hyundai, Kia, Mercedes, Nissan, Opel, Peugeot, Renault, Smart, Subaru, Toyota, Vauxhall, Volvo
Screw torque	1.4 Nm

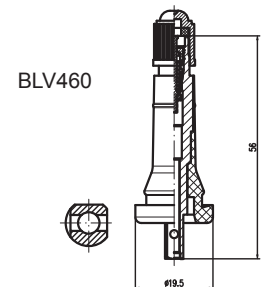

New P/N : 3021

Baolong OLD P/N	TPMSRFBM
Schrader old P/N	66744-KD
Schrader new P/N	5032
Description	Service kit for metal valve for Schrader EZ-sensor
Model	Chevrolet, Citroen, Dacia, Fiat, Ford, Hyundai, Kia, Mercedes, Nissan, Opel, Peugeot, Renault, Smart, Subaru, Toyota, Vauxhall, Volvo
Nut torque	4.0 Nm
Screw torque	1.4 Nm

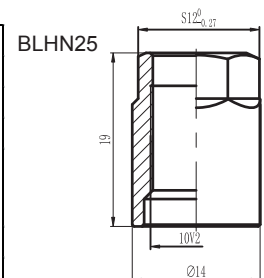

New P/N : 3022

Baolong OLD P/N	BLV724
Schrader old P/N	66743-68
Schrader new P/N	5031
Description	Clamp-in brass valve for Schrader SI/Faraday
Model	Chevrolet, Citroen, Dacia, Fiat, Ford, Hyundai, Kia, Mercedes, Nissan, Opel, Peugeot, Renault, Smart, Subaru, Toyota, Vauxhall, Volvo
Nut torque	8.0 Nm
Screw torque	1.4 Nm

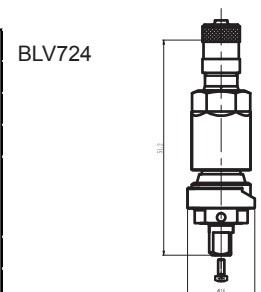

New P/N : 3024

Baolong OLD P/N	BLV745	
Schrader old P/N	N/A	
Schrader new P/N	5061	
Description	Clamp-in aluminum valve for Schrader Faraday and EZ sensor 2.0	
Model	Ford	
Nut torque	8.0 Nm	
Screw torque	1.4 Nm	

BLV745

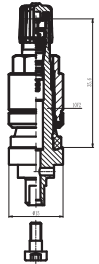

New P/N : 3025

Baolong OLD P/N	BLV745 black	
Schrader old P/N	N/A	
Schrader new P/N	N/A	
Description	Clamp-in aluminum black valve for Schrader Faraday and EZ sensor 2.0	
Model	Ford	
Nut torque	8.0 Nm	
Screw torque	1.4 Nm	

BLV745

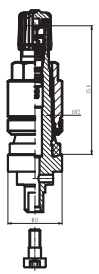

New P/N : 3026

Baolong OLD P/N	TPMSRFBS	
Schrader old P/N	N/A	
Schrader new P/N	5062	
Description	Service kit for clamp-in aluminum valve for Schrader Faraday and EZ sensor 2.0	
Model	Ford	
Nut torque	8.0 Nm	

BLHN96

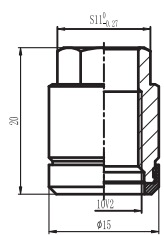

TPMS SERVICE KITS FOR HUF SENSORS

HUF SENSOR



ASSEMBLY INSTRUCTION

- 1) Insert the steel pin into the hole at the bottom of side of the valve stem to avoid rotation of the whole valve stem when install the sensor to the valve.
- 2) Please make sure the sensor touch the wheel firmly after the installation of the sensor.



New P/N : 4001

Baolong OLD P/N	TPMSRFW	
Schrader old P/N	N/A	
Schrader new P/N	N/A	
Description	Service kit for Huf Gen 1	
Model	Alfa Romeo, Alpina, Aston Martin, Audi, BMW, Bentley, Bugatti, Ferrari, Lamborghini, Land Rover, Maserati, Maybach, McLaren, Mercedes, Mini, Pagani, Porsche, Rolls Royce, Skoda, Ssangyong, Tesla, VW	
Nut torque	4.0 Nm	

BLHN61

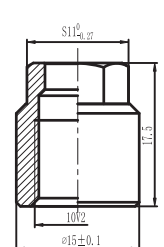

New P/N : 4002

Baolong OLD P/N	BLV497	
Schrader old P/N	65731-67	
Schrader new P/N	5009	
Description	Clamp-in aluminum valve L=43mm for Huf Gen1 RDV001	
Model	Alfa Romeo, Alpina, Aston Martin, Audi, BMW, Bentley, Bugatti, Ferrari, Lamborghini, Land Rover, Maserati, Maybach, McLaren, Mercedes, Mini, Pagani, Porsche, Rolls Royce, Skoda, Ssangyong, Tesla, VW	
Nut torque	4.0 Nm	
Screw torque	4.0 Nm	

BLV497

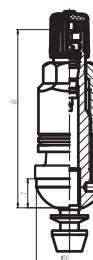
New P/N : 4003

Baolong OLD P/N	BLV476	
Schrader old P/N	65732-67	
Schrader new P/N	5010	
Description	Clamp-in aluminum valve L=48mm for Huf Gen1 RDV002	
Model	Alfa Romeo, Alpina, Aston Martin, Audi, BMW, Bentley, Bugatti, Ferrari, Lamborghini, Land Rover, Maserati, Maybach, McLaren, Mercedes, Mini, Pagani, Porsche, Rolls Royce, Skoda, Ssangyong, Tesla, VW	
Nut torque	4.0 Nm	
Screw torque	4.0 Nm	

BLV476

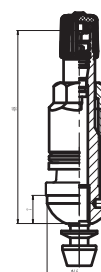
New P/N : 4004

Baolong OLD P/N	BLV477	
Schrader old P/N	65733-67	
Schrader new P/N	5011	
Description	Clamp-in aluminum valve for Huf RDV003 Gen1 valve length L=49mm	
Model	Alfa Romeo, Alpina, Aston Martin, Audi, BMW, Bentley, Bugatti, Ferrari, Lamborghini, Land Rover, Maserati, Maybach, McLaren, Mercedes, Mini, Pagani, Porsche, Rolls Royce, Skoda, Ssangyong, Tesla, VW	
Nut torque	4.0 Nm	
Screw torque	4.0 Nm	

BLV477

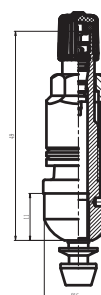
New P/N : 4005

Baolong OLD P/N	BLV496	
Schrader old P/N	65734-67	
Schrader new P/N	5012	
Description	Clamp-in aluminum valve L=51mm for Huf Gen1 RDV004	
Model	Alfa Romeo, Alpina, Aston Martin, Audi, BMW, Bentley, Bugatti, Ferrari, Lamborghini, Land Rover, Maserati, Maybach, McLaren, Mercedes, Mini, Pagani, Porsche, Rolls Royce, Skoda, Ssangyong, Tesla, VW	
Nut torque	4.0 Nm	
Screw torque	4.0 Nm	

BLV496

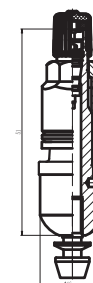
New P/N : 4006

Baolong OLD P/N	BLV492	
Schrader old P/N	66151-67	
Schrader new P/N	5013	
Description	Clamp-in aluminum valve L=56mm for Huf Gen1 RDV005	
Model	Alfa Romeo, Alpina, Aston Martin, Audi, BMW, Bentley, Bugatti, Ferrari, Lamborghini, Land Rover, Maserati, Maybach, McLaren, Mercedes, Mini, Pagani, Porsche, Rolls Royce, Skoda, Ssangyong, Tesla, VW	
Nut torque	4.0 Nm	
Screw torque	4.0 Nm	

BLV492

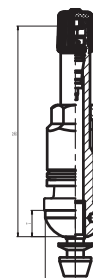

New P/N : 4013

Baolong OLD P/N	BLV746	
Schrader old P/N	N/A	
Schrader new P/N	N/A	
Description	Aluminum valve for Huf sensor for hollow wheels	
Model	BMW	
Nut torque	4.0 Nm	
Screw torque	4.0 Nm	

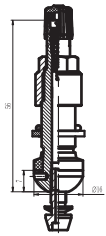
BLV746

New P/N : 4007

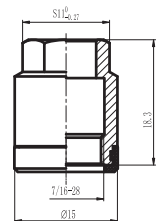
Baolong OLD P/N	TPMSRFAE	
Schrader old P/N	20021, 20023, 20035	
Schrader new P/N	20021, 20023, 20035	
Description	Service kit for Huf Gen2	
Model	Alfa Romeo, Alpina, Aston Martin, Audi, BMW, Bentley, Bugatti, Ferrari, Lamborghini, Land Rover, Maserati, Maybach, McLaren, Mercedes, Mini, Pagani, Porsche, Rolls Royce, Skoda, Ssangyong, Tesla, VW	
Nut torque	4.0 Nm	

BLH88

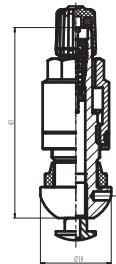
New P/N : 4008

Baolong OLD P/N	BLV472	
Schrader old P/N	5039	
Schrader new P/N	5039	
Description	Clamp-in aluminum valve L=43mm for Huf Gen2 RDV021	
Model	Alfa Romeo, Alpina, Aston Martin, Audi, BMW, Bentley, Bugatti, Ferrari, Lamborghini, Land Rover, Maserati, Maybach, McLaren, Mercedes, Mini, Pagani, Porsche, Rolls Royce, Skoda, Ssangyong, Tesla, VW	
Nut torque	4.0 Nm	

BLV472

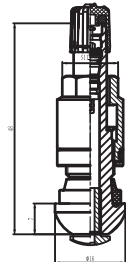
New P/N : 4009

Baolong OLD P/N	BLV495.01	
Schrader old P/N	5040	
Schrader new P/N	5040	
Description	Clamp-in aluminum valve L=48mm for Huf Gen2 RDV022	
Model	Alfa Romeo, Alpina, Aston Martin, Audi, BMW, Bentley, Bugatti, Ferrari, Lamborghini, Land Rover, Maserati, Maybach, McLaren, Mercedes, Mini, Pagani, Porsche, Rolls Royce, Skoda, Ssangyong, Tesla, VW	
Nut torque	4.0 Nm	

BLV495

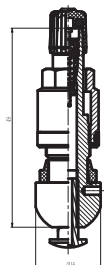
New P/N : 4010

Baolong OLD P/N	BLV702	
Schrader old P/N	5041	
Schrader new P/N	5041	
Description	Clamp-in aluminum valve L=49mm for Huf Gen2 RDV023	
Model	Alfa Romeo, Alpina, Aston Martin, Audi, BMW, Bentley, Bugatti, Ferrari, Lamborghini, Land Rover, Maserati, Maybach, McLaren, Mercedes, Mini, Pagani, Porsche, Rolls Royce, Skoda, Ssangyong, Tesla, VW	
Nut torque	4.0 Nm	

BLV702

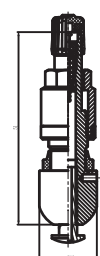
New P/N : 4011

Baolong OLD P/N	BLV703	
Schrader old P/N	5042	
Schrader new P/N	5042	
Description	Clamp-in aluminum valve L=51mm for Huf Gen2 RDV024	
Model	Alfa Romeo, Alpina, Aston Martin, Audi, BMW, Bentley, Bugatti, Ferrari, Lamborghini, Land Rover, Maserati, Maybach, McLaren, Mercedes, Mini, Pagani, Porsche, Rolls Royce, Skoda, Ssangyong, Tesla, VW	
Nut torque	4.0 Nm	

BLV703

New P/N : 4012

Baolong OLD P/N	BLV465	
Schrader old P/N	N/A	
Schrader new P/N	N/A	
Description	Snap-in valve for Huf IntelliSens	
Model	N/A	
Screw torque	4.0 Nm	

BLV465

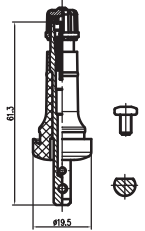

TPMS SERVICE KITS FOR LEAR SENSORS

SENSOR



ASSEMBLY INSTRUCTION

Please refer to the assembly instruction of Huf sensors on page 8.



New P/N : 5007

Baolong OLD P/N	BLV472	
Schrader old P/N	N/A	
Schrader new P/N	N/A	
Description	Clamp-in aluminum valve L=43mm for Lear clamp-in	
Model	Hyundai, Kia	
Nut torque	4.0 Nm	

BLV472

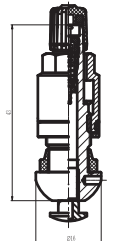

New P/N : 5008

Baolong OLD P/N	BLV462	
Schrader old P/N	N/A	
Schrader new P/N	N/A	
Description	Snap-in valve for Lear snap-in	
Model	Hyundai	
Screw torque	N/A	

BLV462

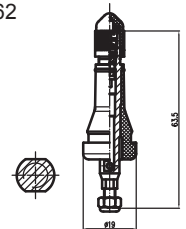

TPMS SERVICE KITS FOR BAOLONG SENSORS

SENSOR



ASSEMBLY INSTRUCTION

Please make sure that the larger diameter of the rubber grommet face toward the sensor during installation.



New P/N : 5009

Baolong OLD P/N	QYV480A-1	
Schrader old P/N	N/A	
Schrader new P/N	N/A	
Description	Clamp-in aluminum valve for Baolong TPMS	
Model	Tesla	
Nut torque	5.0 Nm	
Screw torque	4.0 Nm	

QYV480A-1

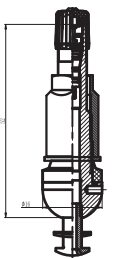

TPMS SERVICE KITS FOR BAOLONG SENSORS

SENSOR



ASSEMBLY INSTRUCTION

Please make sure that the larger diameter of the rubber grommet face toward the sensor during installation.

Please use correct torque when install the screw and the nut.

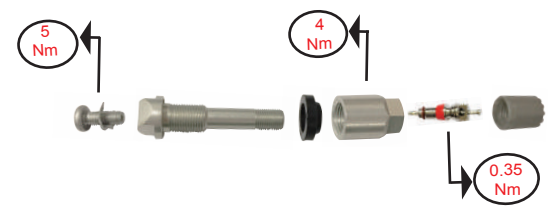

New P/N : 5010

Baolong OLD P/N	QYV480C-1	
Schrader old P/N	N/A	
Schrader new P/N	N/A	
Description	Clamp-in aluminum valve for Baolong X structure	
Model	Changan, FAW	
Nut torque	5.0 Nm	
Screw torque	4.0 Nm	

QYV480C-1

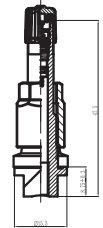

SENSOR



ASSEMBLY INSTRUCTION

Please make sure that the larger diameter of the rubber grommet face toward the sensor during installation. Please use correct torque when install the screw and the nut.



New P/N : 5011

Baolong OLD P/N	BLV717-1	
Schrader old P/N	N/A	
Schrader new P/N	N/A	
Description	Clamp-in aluminum valve for Baolong C and D structure	
Model	BYD, Chery, Dongfeng, FAW, Geely, SGMW	
Nut torque	5.0 Nm	
Screw torque	4.0 Nm	

BLV717-1



SENSOR



ASSEMBLY INSTRUCTION

Please note the brass end shape of the rubber valve stem match the sensor housing during installation. The recommended installation torque of the screw is 1.4 Nm.



New P/N : 5012

Baolong OLD P/N	BLV440	
Schrader old P/N	N/A	
Schrader new P/N	N/A	
Description	Snap-in valve for Baolong C and D structure	
Model	SAIC, Xiali	
Nut torque	N/A	
Screw torque	1.4 Nm	

BLV440

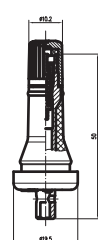

TPMS SERVICE KITS FOR TRW SENSORS

GEN 1



ASSEMBLY INSTRUCTION

Please refer to the assembly instruction of Huf sensors on page 8.



New P/N : 5001

Baolong OLD P/N	BLV497	
Schrader old P/N	65731-67	
Schrader new P/N	N/A	
Description	Clamp-in aluminum valve for TRW Gen 1	
Model	Hyundai, Kia	
Nut torque	4.0 Nm	
Screw torque	4.0 Nm	

BLV497



GEN 2/3



ASSEMBLY INSTRUCTION

Please make sure that the larger diameter of the rubber grommet face toward the sensor during installation.



New P/N : 5002

Baolong OLD P/N	TPMSRFAT	
Schrader old P/N	20022, 20019	
Schrader new P/N	N/A	
Description	Service kit for TRW Gen 2/3	
Model	Acura, Honda, Hyundai, Kia	
Nut torque	4.0 Nm	

BLHN43

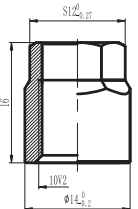

New P/N : 5003

Baolong OLD P/N	BLV474	
Schrader old P/N	N/A	
Schrader new P/N	N/A	
Description	Clamp-in aluminum valve for TRW Gen 2/3	
Model	Hyundai, Kia	
Nut torque	4.0 Nm	

BLV474

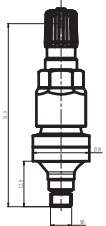

GEN 4



ASSEMBLY INSTRUCTION

Please note the brass end shape of the rubber valve stem match the sensor housing during installation. The recommended installation torque of the screw is 1.4 Nm.



New P/N : 5004	
Baolong OLD P/N	BLV458
Schrader old P/N	20635
Schrader new P/N	N/A
Description	Snap-in valve for TRW Gen 4
Model	Dodge, Jeep
Screw torque	1.4 Nm

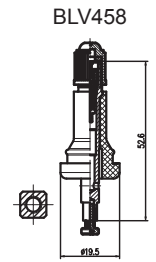

TPMS SERVICE KITS FOR PACIFIC SENSORS

GEN 1/2/3/4

ASSEMBLY INSTRUCTION

Please make sure that the larger diameter of the rubber grommet face toward the sensor during installation.

New P/N : 5005	
Baolong OLD P/N	TPMSRFAN
Schrader old P/N	20032, 20031
Schrader new P/N	N/A
Description	Service kit for Pacific Gen 1/2/3/4
Model	Infiniti, Lexus, Nissan, Peugeot, Subaru, Toyota
Nut torque	4.0 Nm

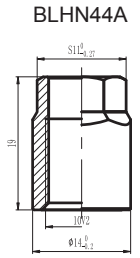

New P/N : 5006	
Baolong OLD P/N	TPMSRFAH
Schrader old P/N	20014
Schrader new P/N	N/A
Description	Service kit for Pacific Gen 1/2/3/4
Model	Toyota
Nut torque	4.0 Nm

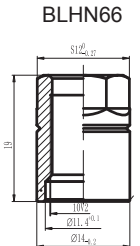

ASSEMBLY INSTRUCTION

Please make sure that the rubber valve is locked on the sensor housing after installation.

New P/N : 5013	
Baolong OLD P/N	BLV442
Schrader old P/N	N/A
Schrader new P/N	N/A
Description	Snap-in valve for Pacific snap-in sensor
Model	Nissan
Nut torque	N/A
Screw torque	clip-in



TPMS SERVICE KITS FOR CUB Uni-SENSORS



ASSEMBLY INSTRUCTION

Please make sure that the larger diameter of the rubber grommet face toward the sensor during installation.



New P/N : 6001

Baolong OLD P/N	TPMSRFBA	
Schrader old P/N	N/A	
Schrader new P/N	N/A	
Description	Service kit for CUB Uni-Sensor	
Model	N/A	
Nut torque	4.0 Nm	

BLHN9AL

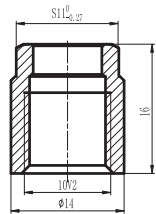

New P/N : 6002

Baolong OLD P/N	BLV718	
Schrader old P/N	N/A	
Schrader new P/N	N/A	
Description	Clamp-in aluminum valve for CUB Uni-Sensor	
Model	N/A	
Nut torque	4.0 Nm	

BLV718

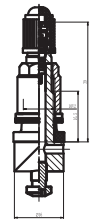

New P/N : 6003

Baolong OLD P/N	BLV718 black	
Schrader old P/N	N/A	
Schrader new P/N	N/A	
Description	Clamp-in aluminum valve black for CUB Uni-Sensor	
Model	N/A	
Nut torque	4.0 Nm	

BLV718

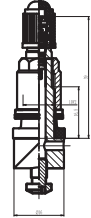

New P/N : 6004

Baolong OLD P/N	BLV464	
Schrader old P/N	N/A	
Schrader new P/N	N/A	
Description	Snap-in valve for CUB Uni-Sensor	
Model	N/A	
Screw torque	1.4 Nm	

BLV464

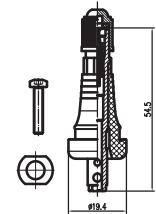

TPMS SERVICE KITS FOR Alligator Sens.It



ASSEMBLY INSTRUCTION

Please refer to the assembly instruction of Huf sensors on page 8.



New P/N : 6005

Baolong OLD P/N	BLV497	
Schrader old P/N	N/A	
Schrader new P/N	N/A	
Description	Clamp-in aluminum valve for Alligator Sens.It	
Model	N/A	
Nut torque	4.0 Nm	
Screw torque	4.0 Nm	

BLV497

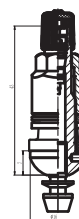
New P/N : 6006

Baolong OLD P/N	BLV463	
Schrader old P/N	N/A	
Schrader new P/N	N/A	
Description	Snap-in valve with clip-pin for Alligator Sens.It	
Model	N/A	

BLV463

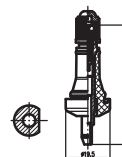

TPMS SERVICE KITS FOR HAMATON T-PRO SENSORS

ASSEMBLY INSTRUCTION

Please make sure that the larger diameter of the rubber grommet face toward the sensor during installation.

New P/N : 6007

Baolong OLD P/N	TPMSRFBB	
Schrader old P/N	N/A	
Schrader new P/N	N/A	
Description	Service kit for Hamaton T-PRO/UNI-PRO	
Model	N/A	
Nut torque	4.0 Nm	

BLHN90

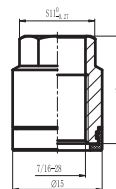
New P/N : 6008

Baolong OLD P/N	BLV719	
Schrader old P/N	N/A	
Schrader new P/N	N/A	
Description	Aluminium valve for Hamaton T-PRO/UNI-PRO	
Model	N/A	
Nut torque	4.0 Nm	
Screw torque	1.4 Nm	

BLV719

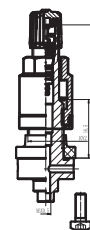
New P/N : 6009

Baolong OLD P/N	BLV462	
Schrader old P/N	N/A	
Schrader new P/N	N/A	
Description	Snap-in valve for Hamaton T-PRO/UNI-PRO	
Model	N/A	
Screw torque	1.4 Nm	

BLV462

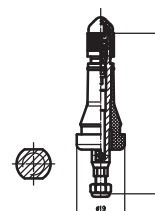
New P/N : 6010

Baolong OLD P/N	BLV726	
Schrader old P/N	N/A	
Schrader new P/N	N/A	
Description	Clamp-in brass valve for Hamaton T T-PRO/EU-PRO	
Model	N/A	
Nut torque	4.0 Nm	
Screw torque	1.4 Nm	

BLV726



TPMS STARTER KIT

Shanghai Baolong Automotive Corporation provides TPMS starter kit with wide assortment of popular TPMS service kits & valves in the market, which covers the replacement demand for most TPMS sensors in the market. All TPMS service kits & valves can be packed in customized heat sealed bags. Besides the 4X4 starter kit box, 3X6 starter kit box is also available upon requirement.

- 88 Service kits
- 8 clamp-in valves
- 4 snap-in valves
- 25 nickel plated valve cores
- 25 nickel plated valve caps



TPMS TOOL KIT

Shanghai Baolong Automotive Corporation also provides the TPMS tool kit servicing all TPMS sensors and valves. This tool kit has been the best selling TPMS tool kit in North American over past years. All tools are stored in a high quality molded case and customized label can be provided.

BEST SELLING TPMS TOOL KIT IN NORTH AMERICA!

<i>TYPE</i>	<i>DESCRIPTION</i>
Valve Core Torque Screwdriver	Valve core torque screwdriver for tightening TPMS valve cores with recommended torque 3.5in-lbs(0.4N.m). Serve as both valve core installer and remover.
TPMS Holding Tool	2 in 1 tool, one side is to hold Beru valve in place for easy installation, the other side is to remove the valve core.
3-Way Fishing Tool - Short	3 in 1 tool, one side is to mount the valve, the other two sides are to deflate the tire and remove the valve core.
T10 Torque Screwdriver	T10 screw torque screwdriver for tightening TPMS snap-in valve to sensor with preset torque 12.5 in-lbs(1.4N.m).
T20 Torque Screwdriver	T20 screw torque screwdriver for tightening TPMS aluminium valve stem to sensor with preset torque 35 in-lbs(4N.m).
4-Way TPMS Tool	4 in 1 tool, quickly removes the TPMS nut (11mm and 12mm hex) and seats new grommets.
TPMS Grommet Tool	Used to remove and install TPMS valve stem grommets.
TPMS Torque Wrench	20-200 in-lbs(2.25-22.5N.m) torque wrench with 3/8" drive and 11mm & 12mm sockets for tightening TPMS nuts.

Shanghai Baolong Automotive Corporation

5500, Shenzhuan Road, Songjiang District, Shanghai 201619, China

Web: www.baolong.biz / E-mail: sbic@baolong.biz / Tel: +86-21-31273333 / Fax: +86-21-31190319



MAKE YOUR WHEELS GO THE DISTANCE

www.baolong.biz
www.baolongtpms.com